

UNCG Elliott University Center, Ferguson Room: Directions

The NC PARC Policy and Trade Working Group Meeting on April 11 will be held in Elliott University Center on the campus of UNCG. Park in the **Walker Avenue Parking Deck**.

Vehicles over 6' 8" high will not be able to enter the deck.

Walker Avenue Parking Deck is located at the corner the corner of Stirling and Theta Streets and Walker Avenue. Parking is available 24 hours a day at the rate of \$1.00 per hour with a \$5 a day maximum.

If the Walker Deck is full, public parking is also available at the Oakland Avenue Deck, approximately 2.5 blocks southeast of the Walker Deck on Forest Street off of Spring Garden. This is a non-attendant deck which requires cash payment (\$1.00 per hour with a \$5 a day maximum) for the cash machines to exit the deck.

Driving Directions to the UNCG Walker Avenue Parking Deck:

From the North and East (Burlington, Raleigh, Richmond, VA):

From I-40/85, follow I-40/Business 85 towards Greensboro/Winston-Salem. Take the Freeman Mill Road/Coliseum Area exit, #218-B. Turn left at the first stoplight onto Coliseum Boulevard. Follow for approximately 1.5 miles and turn right at third stoplight onto Spring Garden Street. Follow for approximately 1.5 miles and turn right at third stoplight onto Spring Garden Street. Follow for approximately .7 miles and take a left onto Stirling Street. Visitor parking is available in the Walker Avenue Parking Deck at the corner of Stirling and Theta Streets (second block on the left).

From the South (Salisbury, Charlotte, Atlanta, GA):

From I-85 North, follow Business 85 towards Greensboro, then take the Coliseum Area exit, #122-B. Follow for approximately 1.7 miles and turn left at the stoplight onto Coliseum Boulevard. Follow for approximately 1.5 miles and turn right at third stoplight onto Spring Garden Street. Follow for approximately .7 miles and take a left onto Stirling Street. Visitor parking is available in the Walker Avenue Parking Deck at the corner of Stirling and Theta Streets (second block on the left).

From the West (Winston-Salem, Asheville, Knoxville, TN):

From I-40 East, take Exit 214 Wendover Avenue East and turn right on Wendover Avenue. Follow Wendover to the exit for Market Street (3.5 miles). Turn right on Market Street and follow for less than 1 mile. Turn right on Aycock Street South. At second stoplight, turn left on Spring Garden Street. One block past the first stoplight, take a left on Stirling Street. Visitor parking is available in the Walker Avenue Parking Deck at the corner of Stirling and Theta Streets (second block on the left).

Other Driving Directions to UNCG Walker Avenue Parking Deck are available at <http://www.uncg.edu/rsh/directions.html#driving>

Walking directions to the Elliott University Center from the Walker Deck:

Elliott University Center (EUC) is directly across Stirling Street from the Walker Avenue Deck. Exit the deck on the Stirling Street side through the main exit on the third floor, near the elevators and cross the street. EUC is directly ahead.

A campus map can be printed from this website:

http://www.uncg.edu/online_map/2dmap/nameMap.htm

Locate Walker Parking Deck and Elliott University Center (EUC)

Ground floor EUC

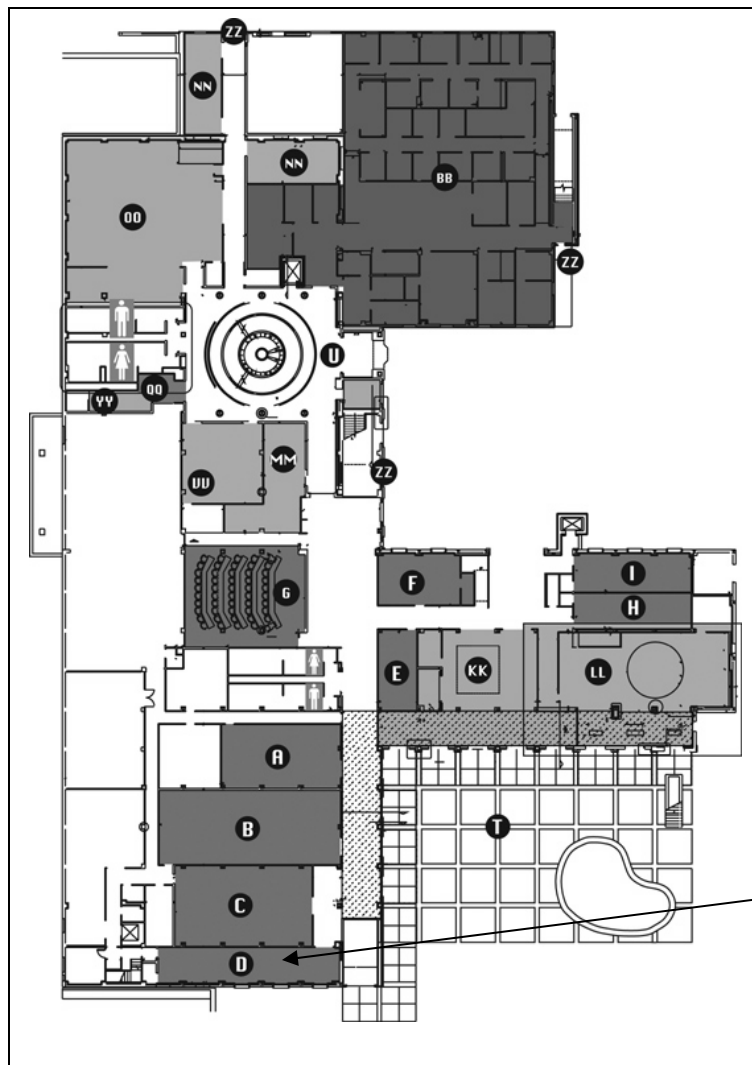

Ferguson Room (D)
Ground floor EUC